

Front Profile SP55

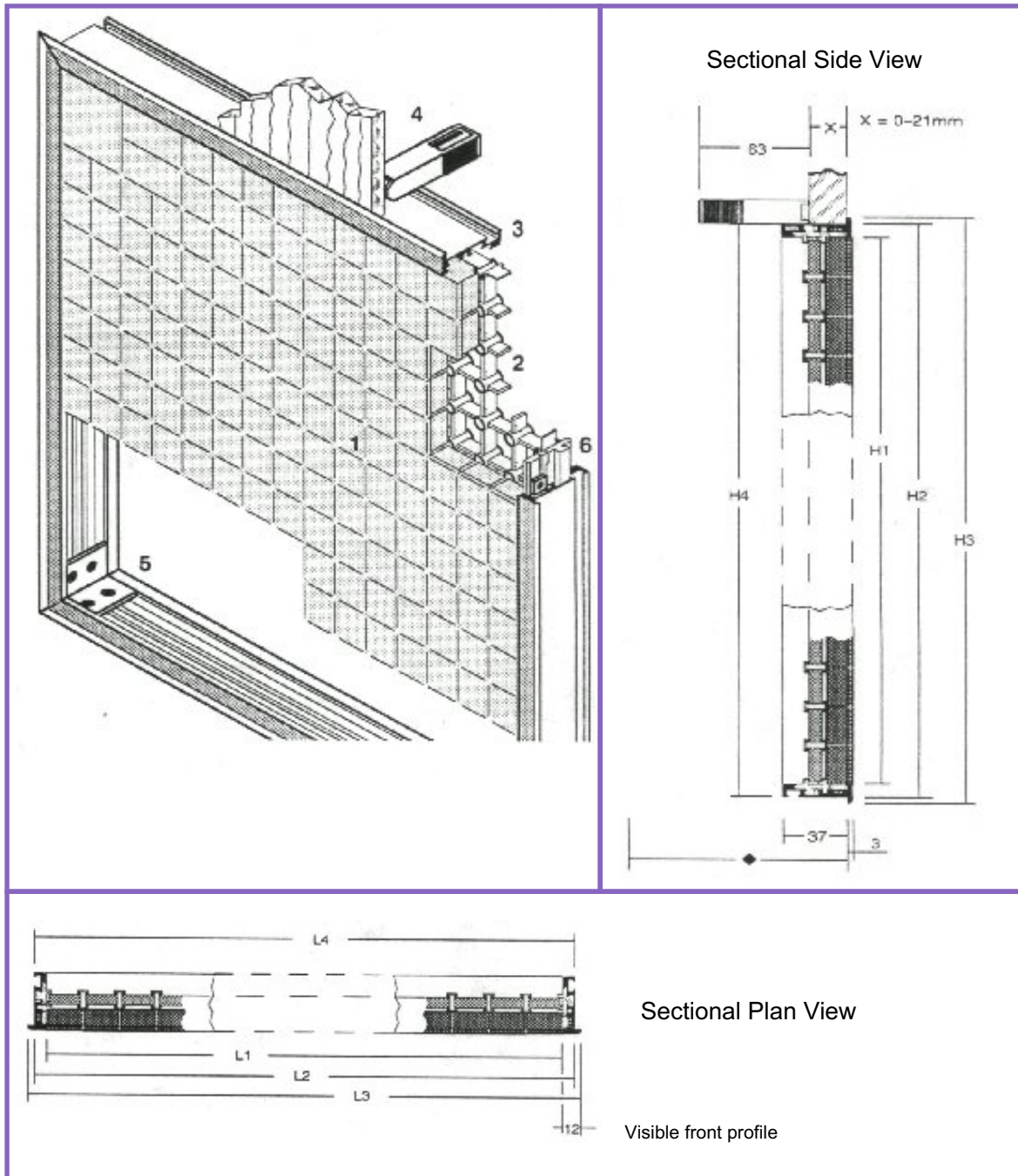

- Key:**
- 1 = Tile SM24
 - 2 = Grid 576x288
 - 3 = Front profile SP55
 - 4 = Fixing clamp
 - 5 = Corner bracket
 - 6 = Grid mounting set

- Makrolon ®
- Zn die-cast
- Anodised* Aluminium
- Zn die-cast
- Aluminium
- Plastic

* Standard Silver

- Dimensions:**
- L1 = Nominal mosaic area
 - L2 = Rear frame
 - L3 = Outer frame
 - L4 = Required aperture size
 - H1 = Nominal mosaic area
 - H2 = Rear frame
 - H3 = Outer frame
 - H4 = Required aperture size

- All in mm**
- nx24
 - nx24+ (2x8)
 - nx24+ (2x12)
 - nx24+ (2x9)
 - nx24
 - nx24+ (2x8)
 - nx24+ (2x12)
 - nx24+ (2x9)

©TEW 2008. All rights reserved. This is the property of TEW. Unless you obtain the express written permission of TEW, no part shall be used, reproduced, divulged or made available to any third party and disclosure to you does not confer any right or licence.

Ref: o8o8o8



UK
www.tew.co.uk

Germany
www.tew-eng.de

Australia
www.tew-eng.com.au

Providing worldwide solutions

Automation • Control & Indication • Information & Display